

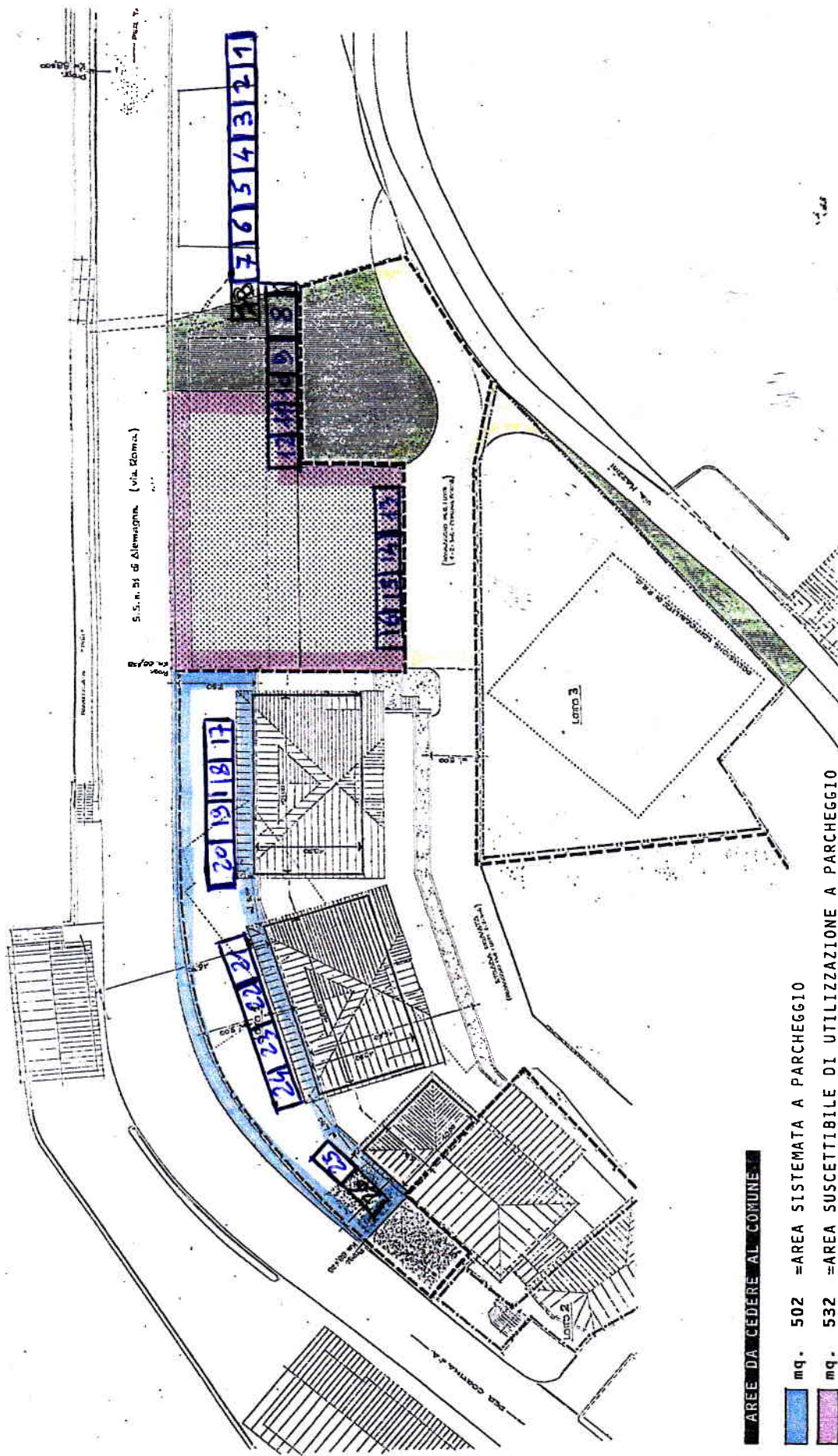





Numero espositori: 25.

Modulo espositore: 4x3 metri.

11/10/88
ALCS CONVOGHI-1/13
C/16/1/1/12



AREE DA CEDERE AL COMUNE

-  mq. 502 = AREA SISTEMATA A PARCHEGGIO
-  mq. 532 = AREA SUSCETTIBILE DI UTILIZZAZIONE A PARCHEGGIO
-  mq. 424 = AREA PER ALLARGAMENTI STRADALI E VARIE
-  mq. 301 = SERVITU' DI TRANSITO CARRABILE
-  mq. 170 = SERVITU' DI TRANSITO PEDONALE SU PORTICATO

13/10/1988
TALAMINI DANIELE
Collegio
dei Geometri
Prov. di
BELLUNO
N. 321